



The RCWAV retard chamber is designed for installation in the alarm trim of wet alarm valves, delaying water flow to the alarm device to prevent false activations. It features a durable epoxy-coated exterior.

Characteristics

- Inlet: ½" BSPT.
- Outlet: ¾" BSPT.
- Internal volume: 3,5 L.
- Weight (only ball): 5,7 kg.
- FM approved for use with the Profit FACV & GACV alarm check valve.

Corrosion protection

With a high-quality epoxy coating on the outside.

Working pressure

- 2,07 MPa / 20,7 bar / 300 psi.
- Testing pressure: 4,00 MPa / 40,0 bar / 600 psi.

Marking & dimensions

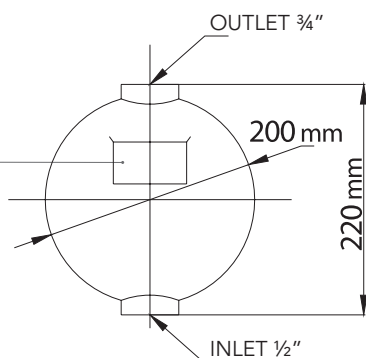

Installation

- The retard chamber is installed in the wet alarm valve alarm trim.
- The retard chamber needs to be supported on site.

Example application wet alarm valve, type GACV.

Retard chamber for wet
alarm valves, type RCWAV



GENERAL INFO

- Installers should be trained or experienced to install and understand the product.
- Read and understand all technical datasheets and installation instructions before attempting to install, remove or adjust any Profit piping products.
- Depressurise and drain the sprinkler installation system before attempting to install, remove or adjust any Profit piping products.
- Never work on piping systems that are pressurised and / or filled with water.
- Piping Logistics reserves the right to change specifications, designs and / or standard equipment without notice and without incurring in any obligations.
- Use the necessary Personal Protection Equipment (PPE) to avoid personal injury (helmet, safety shoes and goggles, Profit gloves).



Failure to follow these instructions could result in death or serious injury and property damage.

We advise to always store our products in closed and dry environments, the products do not need any specific maintenance once installed on an aboveground sprinkler installation.

REVISION TABLE

Date	△	Notes
18/03/2025		Initial release.